

PLAN FOR EXISTING 3-NOS.BLOCKS - A,B & C
OF A G+IV STORIED RESIDENTIAL PROJECT OF
SAMAR GHOSH
ATMOUJA-SHALEPUR,J.L.NO.-33,R.S & L.R.DAG
NO.-176,UNDER KHATIAN NO.-2078,UNDER
HARIHARPUR GRAM
PANCHAYET, P.S.-BARUIPUR, DIST.-24 PGS.(S).

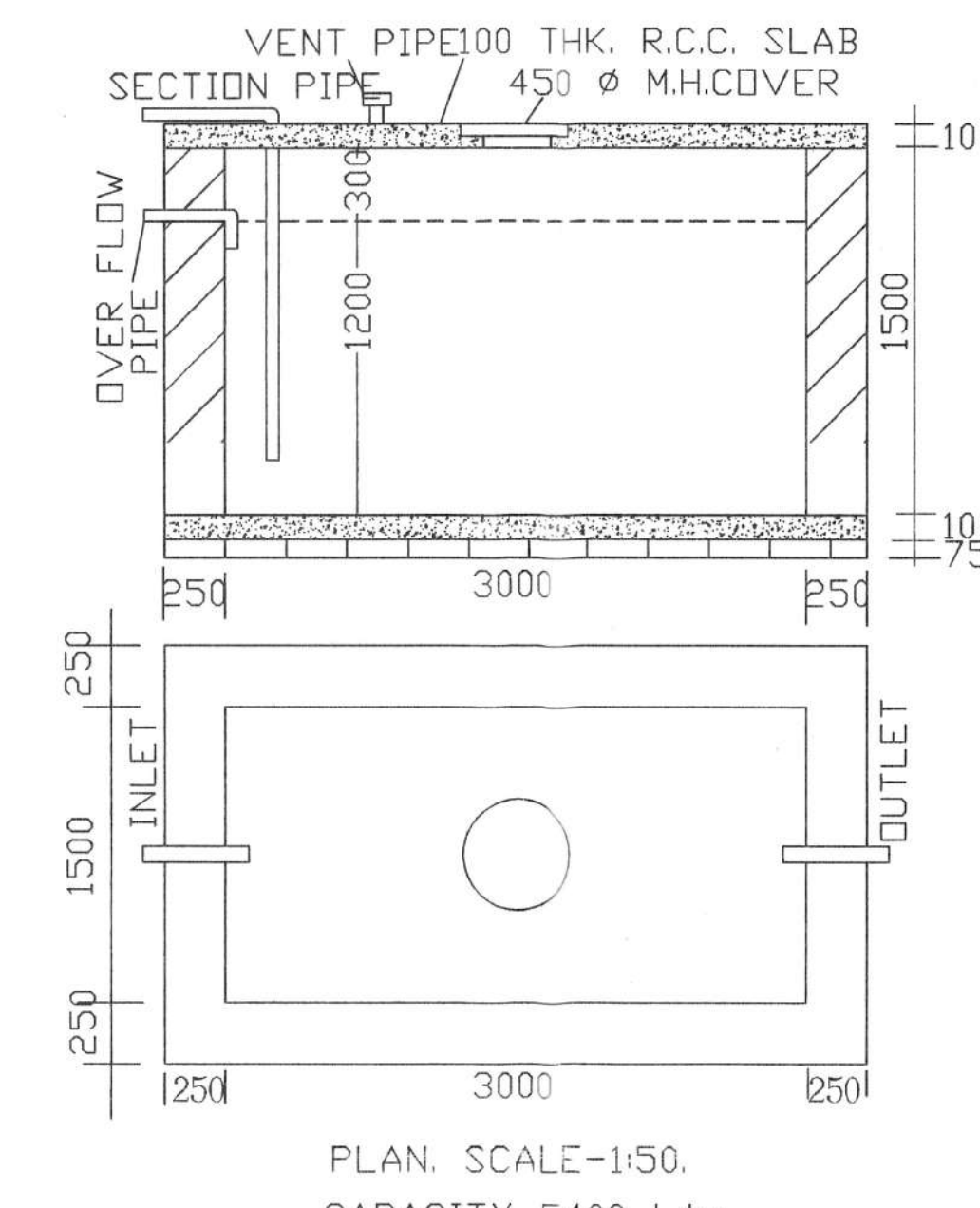
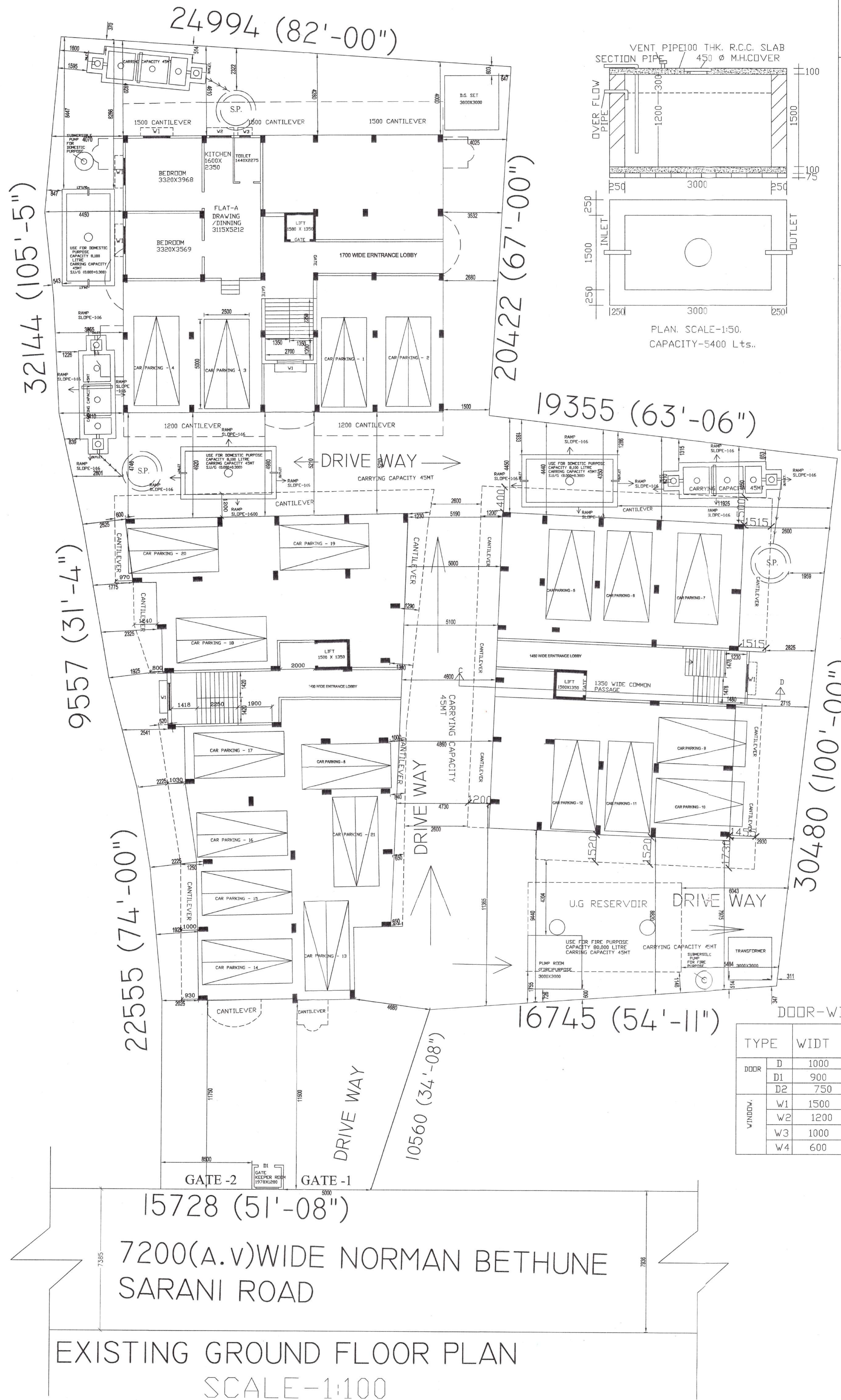
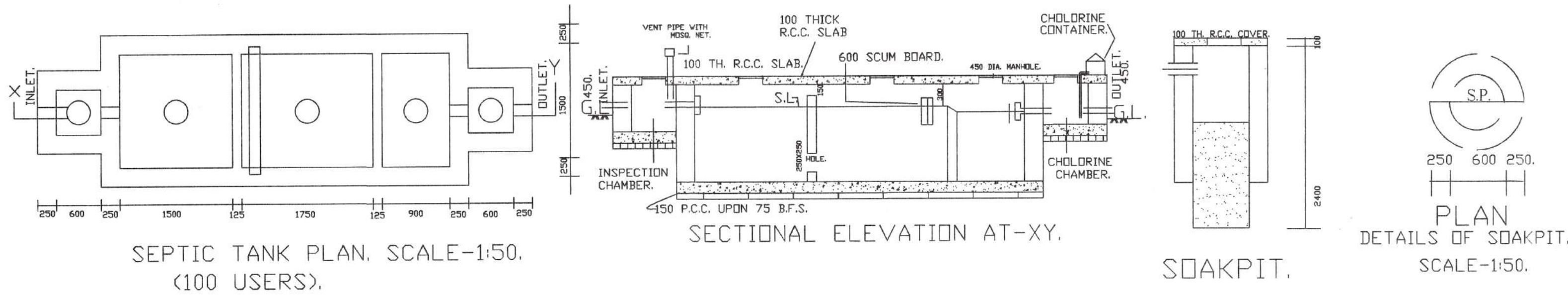

STATEMENT OF THE PLAN PROPOSAL :

NO. OF STOREY INDICATING: G+IV
TOTAL COVERED AREA PROVIDED: 5057.109SQM

AREA OF LAND AS PER DEED : 42.75 SATAK.
=1730.659 SQM..
AS PER PHYSICAL =1730.567 SQM.

MEANS OF ACCESS : 7.2 M(A.V) WIDE ROAD.

PERMISSIBLE HEIGHT :14.5 M.
TOTAL HEIGHT PROVIDED:14.5 M.
NO. OF TENAMENTS : 58.

IT IS CERTIFIED THAT THE BUILDING PLAN HAS BEEN DRAWN UP AS PER PROVISION OF RAJPUR-SONARPUR MUNICIPALITY. BLDG. RULES AS AMENDED FROM TIME TO TIME AND THAT SITE CONDITION INCLUDING THE WIDTH OF THE ABUTTING ROAD CONFORMED WITH THE PLAN & CERTIFIED THAT IT IS A BUILDABLE SITE AND IT IS INFORMED BY THE OWNER THAT IT IS NOT A TANK OR FILLED UP TANK . THE PLOT IS DEMARCATED BY BOUNDARY WALL.

KALLOL KUMAR GHOSHAL
B.E (CIVIL) MIE
Chartered Engineer
Membership No. 100622
Regd. No. 87783 FRC
KMC Empatment No. ESE/11/281

Siddhi Vinayak
Partner

Siddhi Vinayak
Partner

SIG. OF ENGINEER

SIG. OF OWNERS

FOR OFFICE USE ONLY

DETAILS OF TOTAL FLOOR AREA :

BLOCK-A
AREA OF G.R. FL. - 326.000 SQM.
AREA OF 1ST. FL. - 395.996 SQM.
AREA OF 2ND.FL. - 395.996 SQM.
AREA OF 3RD.FL. - 395.996 SQM.
AREA OF 4TH.FL. - 395.996 SQM.
TOTAL FLOOR AREA: 1909.984 SQM.

BLOCK-B
AREA OF G.R. FL. - 237.306 SQM.
AREA OF 1ST. FL. - 322.425 SQM.
AREA OF 2ND.FL. - 322.425 SQM.
AREA OF 3RD.FL. - 322.425 SQM.
AREA OF 4TH.FL. - 322.425 SQM.
TOTAL FLOOR AREA: 1527.006 SQM.

BLOCK-C
AREA OF G.R. FL. - 227.034 SQM.
AREA OF 1ST. FL. - 341.236 SQM.
AREA OF 2ND.FL. - 341.236 SQM.
AREA OF 3RD.FL. - 341.236 SQM.
AREA OF 4TH.FL. - 341.236 SQM.
TOTAL FLOOR AREA: 1591.978 SQM.

SPECIFICATION

FOUNDATION- ISOLATED COLUMN FOOTING WITH PROPER REINFORCEMENTS AND CONCRETE MIX M25

BRICKWORK- IN CEMENT MORTAR WITH CEMENT SAND MIX 1:6 IN 200 THK WALL. AND IN 125/75 MM THK WALL. CEMENT SAND MORTAR IS 1:4

LINTELS, ROOF- R.C.C ACCORDING TO STRUCTURAL DRAWING.

FLOORING - MARBLE FLOORING.

PLASTERING - CEMENT SAND MORTAR IN 1:5.

WOODWORK -SAL WOOD FOR DOOR FRAME AND FLUSH DOOR FOR SHUTTER.

GRILL WORK -MILD STEEL GRILL FOR WINDOW'S, HANDRAIL AND COLLAPSIBLE GATE FOR MAIN ENTRANCE.

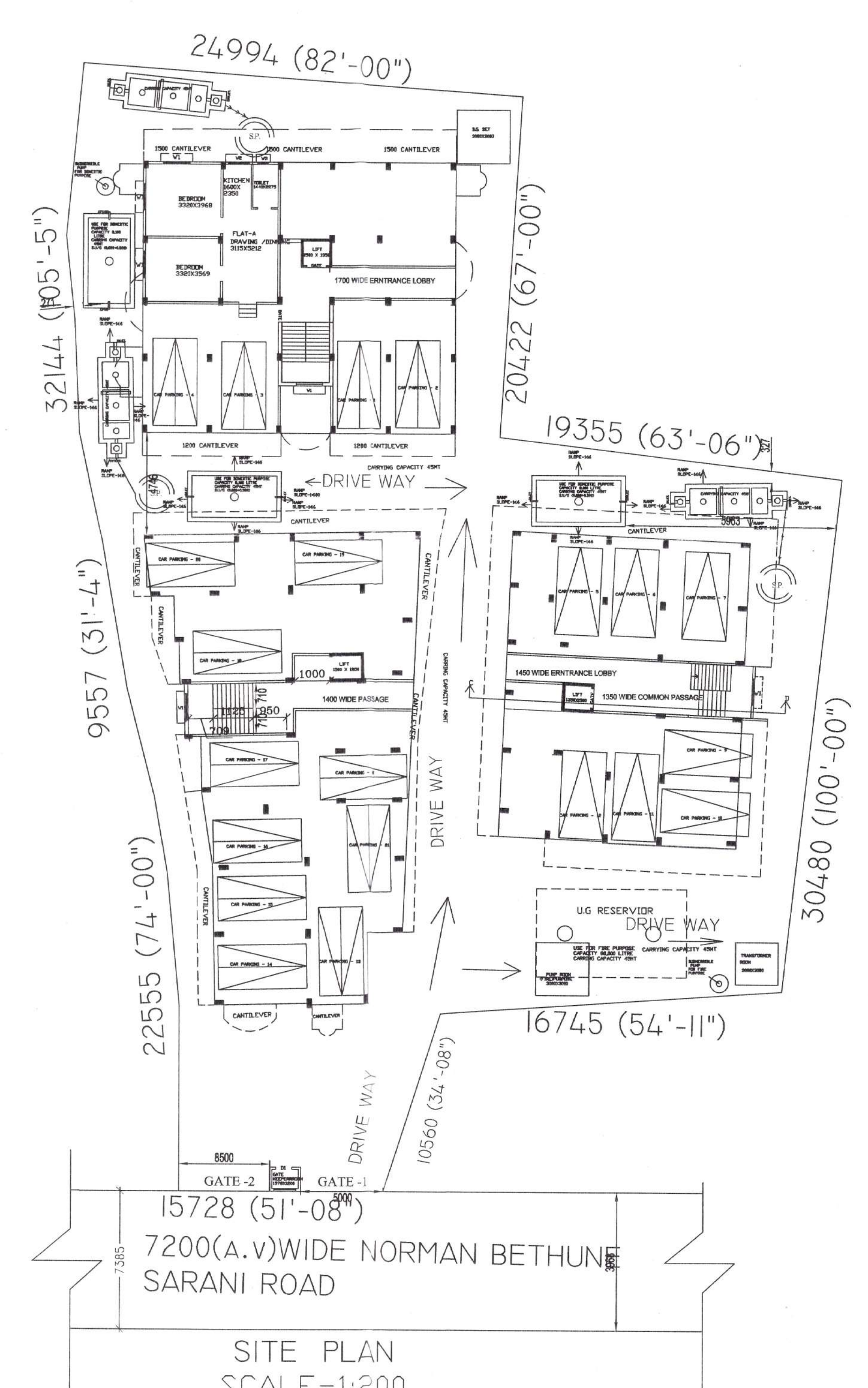

DOOR-WINDOW

TYPE	WIDT	HEIGHT
DOOR		
D	1000	2000
D1	900	2000
D2	750	2000
WINDOW		
W1	1500	1200
W2	1200	1200
W3	1000	1200
W4	600	600

REVISED SANCTIONED PLAN

File No. 638/768/Rev/KMDA

1. There should not be any court case or any complains from any corner in respect of the said property as per plan.
2. "South 24 Parganas Zilla Parishad" will not be liable if any dispute arises at the site.

[Handwritten Signature]
ASSISTANT ENGINEER
South 24 Pgs. Z.P.

[Handwritten Signature]
District Engineer
South 24 Pgs. Z.P.